



The approach at either end will be gently ramped and terraced, becoming a city park and vibrant streetscape. The entire bridge will be raised by eight feet, maintaining water access and allowing the Harborwalk to pass beneath the bridge.



The roadway will be rated for traffic and light rail so that it may accept the occasional vehicle for festivals, and mass transit as the Seaport develops. The swing portion of the bridge will be pivoted and fixed closed referencing its' industrial engineering.



Curved ramps provide access to the public docks featuring a toe dip pool, and the historically restored Tender's House, reused as a local cafe.



# PIVOT POINT BRIDGE A TWIST ON A BOSTON ICON



The crowning jewel is the Garden Roof Deck, an outdoor park above the center portion of the bridge. The self sustaining nature of the bridge is demonstrated by the circular solar panels integrated into the structure, generating the power needed for lighting and providing a natural canopy. This space will serve as an authentic display space for historic and cultural exhibits, a meeting point, a viewing platform for sweeping vistas of the harbor and skyline, and as a city retreat into nature.

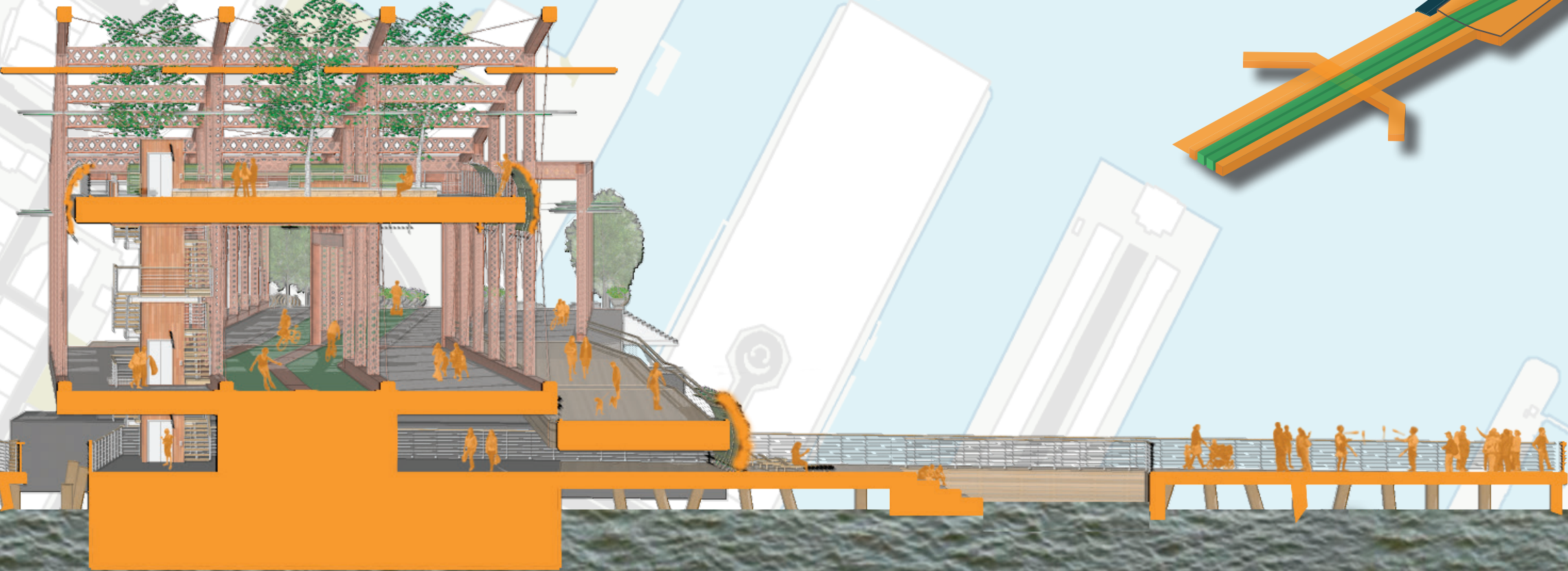
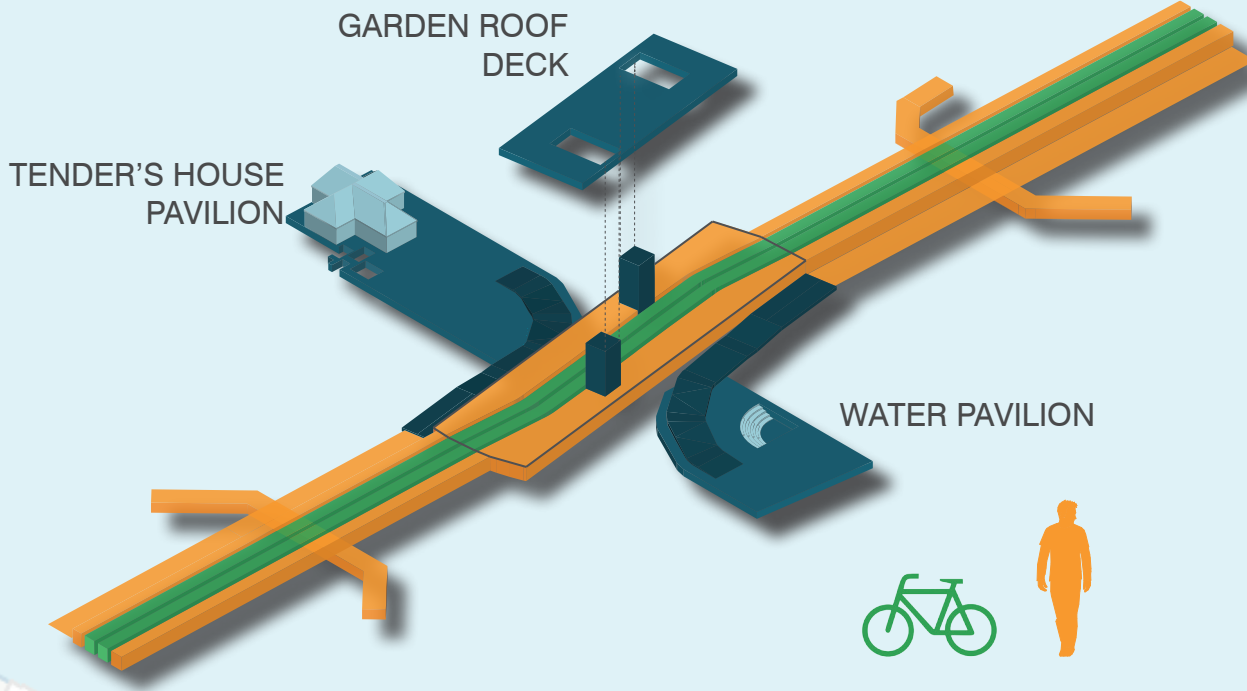

PLAN VIEW